

# A VENDRE

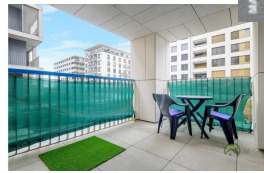

Energy index



## APARTMENT

- Additional costs : 250.00 €
- Bedroom(s) : 1
- Surface : 56.00 m<sup>2</sup>
- Availability : à convenir
- Reference : 1891
- Year of constr. : 2018

**Price :**  
**635.000 euros**

**Surface :**  
**56.00 m<sup>2</sup>**

**Isolation index :**  
**a**

Located conveniently for nearby amenities is this lovely one bedroom apartment with Loggia 9sq.m.

Cloche d'Or is a smart area, close to the City center, Mall , bus and Tram lines, station, bars, restaurant.

It is the place to be.

The accommodation is superbly appointed throughout and in brief comprises: Communal entrance hall, it is on groundfloor , loggia ( 9 sq.m) living room / kitchen (29 sq.m) with appliances, restroom, one bedroom, bathroom, (it is actually rented).

You can buy a parking spot â,~ 70,000.-. It is not included in the sale price.

Currently, it is rented.

Agency fee 3% charged to the seller.

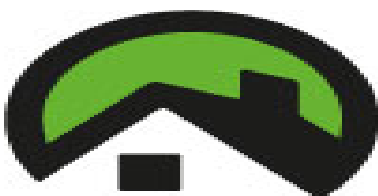

**MGI**

75 parc d'activité  
L-8308 Capellen  
+352 26 10 20 51

LUXEMBOURG-GASPERICH

635.000 euros

# A VENDRE

For any viewing, do not hesitate to contact the agency by email:  
info@mgi.lu or by phone: +352621375725.

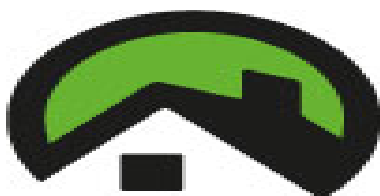

**MGI**

75 parc d'activité  
L-8308 Capellen  
+352 26 10 20 51

---